



www.tenker.co



support@tenker.co



1-855-558-8666(24 Hours Mon-Fri)

CONTENTS

FCC COMPLIANCE STATEMENT

PRECAUTIONS

GETTING READY

Package Contents

Knowing the device

BASIC OPERATIONS OF THE PROJECTOR

Turning On/Off the Projector

Adjusting Focus

Resizing the Projection Screen

Charging Battery

PROJECTING FROM THE PROJECTOR

HDMI connection

Micro SD Card

Wi-Fi Display

PRODUCT MAINTENANCE

SPECIFICATIONS

TROUBLE SHOOTING

Thank you for purchasing our mini projector. Please read this manual carefully and keep it in a safe place for future reference.

Product names and trademarks involved in the Manual are for illustrative and identification purposes only. All of them are the registered trademarks or copyrights of their original companies.



FCC COMPLIANCE STATEMENT:

This equipment has been tested and found to comply with the limits for a Class B digital device, pursuant to Part 15 of the FCC Rules. These limits are designed to provide reasonable protection against harmful interference in a residential installation. This equipment generates uses and can radiate radio frequency energy and, if not installed and used in accordance with the instructions, may cause harmful interference to radio communications. However, there is no guarantee that interference will not occur in a particular installation. If this equipment does cause harmful interference to radio or television reception, which can be determined by turning the equipment off and on, the user is encouraged to try to correct the interference by one or more of the following measures:

- Reorient or relocate the receiving antenna.
- Increase the separation between the equipment and receiver.
- Connect the equipment into an outlet on a circuit different from that to which the receiver is connected.
- Consult the dealer or an experienced radio/TV technician for help.

This device complies with part 15 of the FCC Rules. Operation is subject to the following two conditions:

- (1) This device may not cause harmful interference.
- (2) this device must accept any interference received, including interference that may cause undesired operation.

You are cautioned that any change or modifications to the equipment not expressly approved by the party responsible for compliance could void your authority to operate such equipment.



If the time arises to throw away your product, please recycle all the components possible. Batteries and rechargeable batteries are not to be disposed in your domestic waste! Please recycle them at your local recycling point.

PRECAUTIONS

- 1.To prevent electric shock, do not open the case. If needed, please ask your local dealer or send back to factory for repair.
- 2.When operating the projector, please do not look into the lens, as this may cause eyes injured.
- 3.To prevent fire or electric shock, do not operate this product in wet or moisture environment.
- 4.For best results, try to use the product in a dark environment.
- 5.When using the projector, please avoid dropping or impact, so as not to damage the internal parts.
- 6.Always use the standard power adapter for the projector.
- 7.Please unplug the AC adapter from the projector when it is not used, unless charging the projector.

GETTING READY

PACKAGE CONTENTS

Including mini projector, Power adapter, Mini HDMI cable, Mini HDMI adapter, Tripod and User manual.

KNOWING THE DEVICE

• The Projector

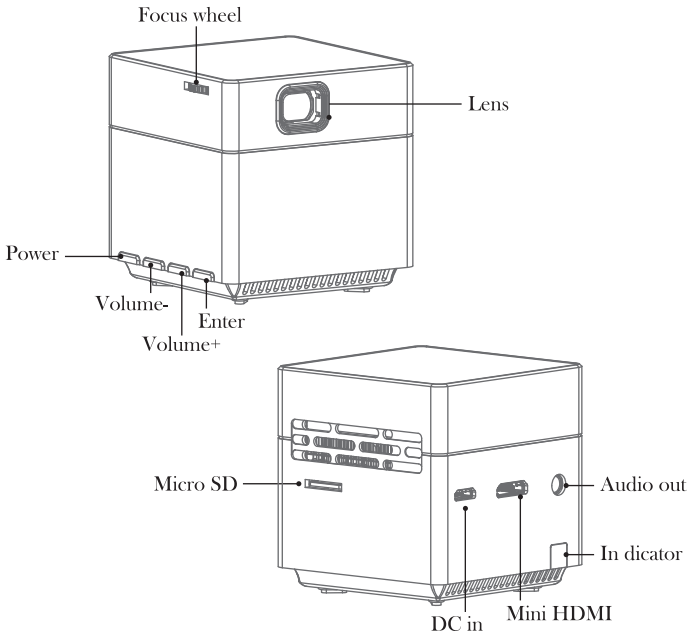

• KEY OPERATION



"Power" key; "Return" key under sub-menu.



"Volume-" and "Previous" key.



"Volume+" and "Next"key.



"Enter" key: "Play/Pause" function in playback menu; " System menu" function in HDMI mode.

• REMOTE CONTROLLER

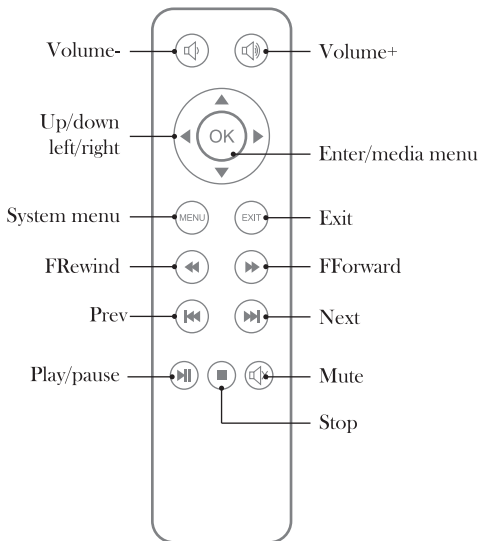

• NOTE

- * Handle your remote controller carefully. Dropping or jarring can damage internal components.
- * Exposure to direct sunlight, smoke or steam can harm internal components.

• USER INTERFACE

You will see the following options on the home screen:



• SETUP

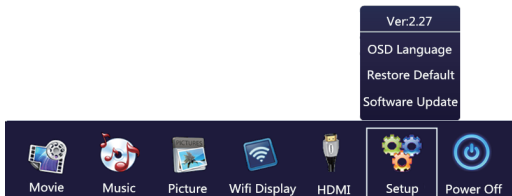

The system setting menu includes options to select Language and reset to factory default. Do NOT use the option "System update". They are for manufacturer maintenance only.

BASIC OPERATIONS OF THE PROJECTOR

• TURNING ON/OFF THE OPERATION

Press and hold the power button for 3 seconds to turn on the projector, the indicator becomes blue.

Projector can be turned off in 2 ways:

a: Press the power button for 3 seconds.

b: In the home screen select the Power option and then select "YES" by pressing "OK" in the remote .

• ADJUSTING FOCUS

1. Roll the focus ring to adjust the clarity of the projected image.
2. Stop rolling the ring once the projected image becomes clear.

• RESIZING THE PROJECTION SCREEN

The projection screen size is highly related to the distance from the projector to the projected wall. Please refer to the following table for the relationship of projection distance and screen size.

The larger projection screen will require darker environment to ensure better projected image.

Screen Size (Unit: Inch)	Project Distance (Unit: M)
7	0.18M
38	1M
56	1.5M
100	2.5M

Note: The measured values are estimated for reference only.

• CHARGING BATTERY

The projector can be power by AC adapter or internal rechargeable battery. To have maximum battery life, it is highly suggested to charge the battery for at least 4 hours the first time.

- 1.Ensure the projector is turned off and connect it to the power charger.
- 2.Insert the plug of the power charger into the wall outlet to charge the battery.

★ Indicator Lights Status

	Turn off	Turn on
Red Light	Charging	Charging
Blue Light	×	Working

Note : The battery capacity status will be shown on the upper corner of projector main screen.

- ★ Icon will appear on the screen when the power adapter is connected or when the battery is full.
- ★ Icon will appear on the screen when the projector is running low on battery. Please power the projector by AC adapter when battery is low.

PROJECTING FROM THE PROJECTOR

• HDMI

Projecting the display screen from computers, DVs, DSC or other HDMI source devices like PS4, Xbox 360 game consoles via HDMI cable connection.

• MICRO SD CARD

Insert the Micro SD card in right way to playback contents, you can use the keys on the projector or remote controller to select Movie, Picture or Music.

Note: Please refer to the below correct way of insertion :



• MOVIE

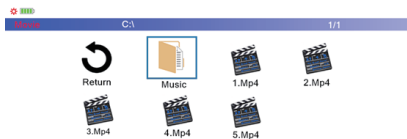

Use this option to play movies and videos stored on the Micro SD card.

• PICTURE



This option can be used to view pictures stored on the Micro SD card.

• PICTURE

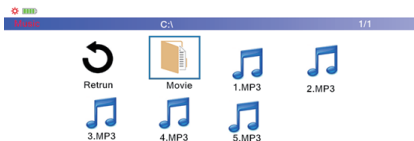

This option can be used to play music from storage media.

• WI-FI DISPLAY

It integrated most advanced Wi-Fi 802.11 b/g/n for both 2.4Ghz switch to prevent traditional 2.4Ghz channel crowded problem. It doesn't only support Miracast for Android devices, but also support AirPlay for IOS devices.

• NOTE:

1. AirPlay/Miracast switch: Press "■" key on the projector or "OK" key in the remote.
 2. Before mirroring, please wait until the "SSID" and "PSK" to appear.
 3. The first time using it, user need to enter the password (PSK: XXXXXXXX) when connecting Wi-Fi hotspot.
 4. The fluency for mirroring the media may be interfered due to obstructions or distance between your device and this projector, also including complicated Wi-Fi environment.
- The distance recommended is less than 3 meters.

• APPLE IOS EQUIPMENT (AIRPLAY)

On projector home screen, Select "Wi-Fi Display", then MS screen will show up. Please change default Miracast to Airplay mode by pressing "■" key on the projector or "OK" key in the remote.

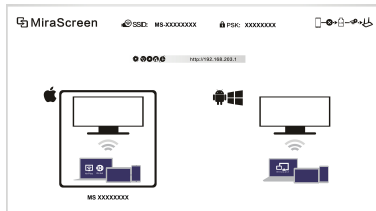

From your Apple device. go to Settings, "MS "will be shown as WIFI hotspot. Select "MS" hotspot, then choose Airplay, confirm to start mirroring. See the following pictures from left to right.

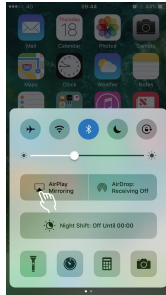
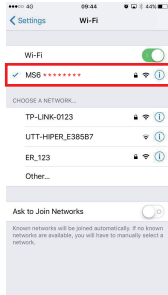
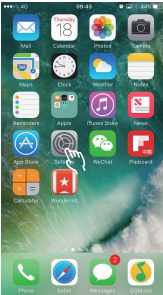

• IMPORTANT NOTICE

When you want to mirror the screen and receive internet data from Wi-Fi at the same time, after connecting the MS, you must open your web browser to edit settings in the IP address 192.168.203.1, then click "Internet" and connect the internet Wi-Fi . Please see the instruction of Setting.

User can also use phone's data plan even without Wi-Fi network.

• MIRACAST

On projector home screen, select "WIFI Display", then MS screen will show up. The default mode is Miracast .

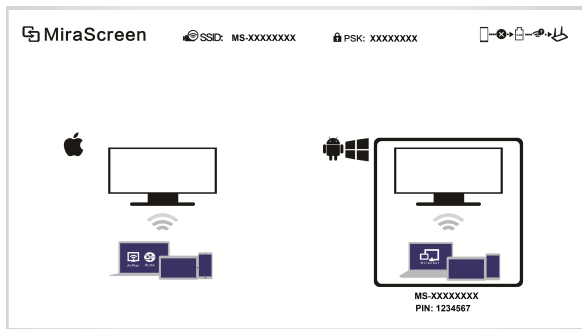

Note: Different brand may have different wireless connection name and settings. Please refer to the manual of each equipment.

• FOR SAMSUNG EQUIPMENT:

Method 1 : Settings-More networks-Screen mirroring-Choose MS ID on the list. After successfully connected, the projection image will be the

same as the image on your phone. See the following pictures from left to right.

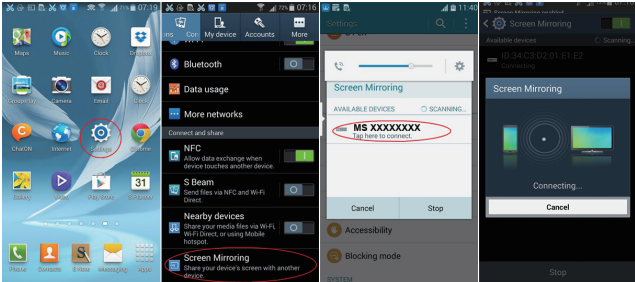

Method 2: Slide downward from the top of Android OS equipment to display the hidden menu-Select "Screen Mirroring"- Choose MS ID on the list. After successfully connected, the projection image will be the same as the image on your phone.

For example, Samsung Note 5/6/7 named "SmartView" for wireless mirroring. See the following pictures from left to right.

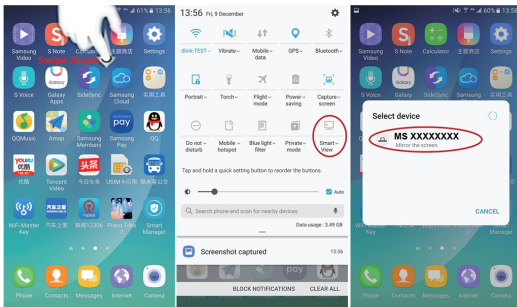

• SETTING

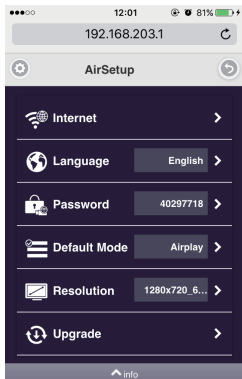

After Wi-Fi is connected with MS, you can open your web browser to edit settings, please enter IP:192.168.203.1 (Sample fig.is based on mobile device)

There are 6 setting functions:

INTERNET: Set up MS to link with home router to keep internet surfing (Please be noted your connection between mobile device and MS may disconnect when you link it to Home router at the 1st time)

LANGUAGE: Multiple languages for selection

PASSWORD: Change default WIFI password

DEFAULT MODE: Select Airplay or Miracast as default after booting

RESOLUTION: Setup output resolution

UPGRADE: Latest firmware upgrade (Please be noted this will require internet connection)

PRODUCT MAINTENANCE

• THE PROJECTOR

Charge the battery for at least 4 hours the first time.

If the projector is dirty, you can wipe with a dry cloth. Do not wipe with a damp cloth.

• REMOTE CONTROLLER

PRODUCT SPECIFICATIONS

Name	Mini Projector
Native resolution	854*480 (FWVGA)
Compatible resolution	640*480~1920*1080
Wireless Connectivity	Miracast (Android), Airplay(iOS)
Light source	RGB LED
Focus	Manual adjust
Brightness(ANSI)	100 Lumens
Contrast ratio	1000:1
Power supply	DC 5V/2A (Micro USB type)
Power consumption	8.5W
Built-in Speaker	8Ω1W(x1)
Input	Mini HDMI/ Micro SD slot (up to 64GB)
Output	Audio output (ϕ 3.5mm)
Battery	3.7V 2500MAH
Dimension(LxWxH)	55*55*55mm
Weight	174g
LED working life	Above 30000 hrs
Relative working humidity	10%~90%
Supported Photo file formats	PNG/BMP/JPEG/JPG
Supported Video file formats	DAT/FLV/MKV/MOV/MP4/MPG/RM/TRP/TS/WMB/RMVB
Supported Audio file formats	AAC/FLAC/M4A/OGG/MP3/WAV/WMA

Note : The specifications are subject to change without notice.

TROUBLE SHOOTING

Q : Why is projector blue indicator on, the projection screen has not yet come out?

A : Make sure not to press and hold the power key too long. Release the power key as soon as the blue indicator is on. Please be patient and not to push the power key repeatedly during the projector system is booting. Otherwise that may cause the projector stuck.

Q : When the projector is in use, it abruptly quits the playback screen?

A : Normally the projector will be back to system home page or stop working easily if the blue touch buttons are touched during playback.

Q . Why can I not play the files from my SD card?

A: Please check :

1. If the capacity of this SD card is higher than 64GB? The capacity supported by the projector is only up to 64GB.
2. If the SD card is not standard compliant.

Q : Why can some movies not be played?

A: In this case there are several possibilities.

- 1.The file size is too large.
- 2.The video resolution is higher than 1080p. The supported resolution is only up to 1080p.
- 3.The file format is not supported. Please refer to the video format support list in Specifications chapter.

Q : Why does playing movie have no sound coming out?

A : Due to the copyright issue of Dolby, this projector does not support

Dolby audio decoding. You might not get sound from videos if they use Dolby audio decoding.

Q : How should I do if the projector system is crashed or stuck?

A: In this case there are several possibilities that will cause the system crash sometimes.

- 1.The computing power of the projector cannot catch up the one of the connected devices.
2. The mismatched display resolutions between the projector and the connected device.
- 3.The serious wireless network traffic between the projector and the connected device.

The possible solution is to restart the projector and the router.
Then the projector will work normally.

TENKER

MINI PROJECTOR

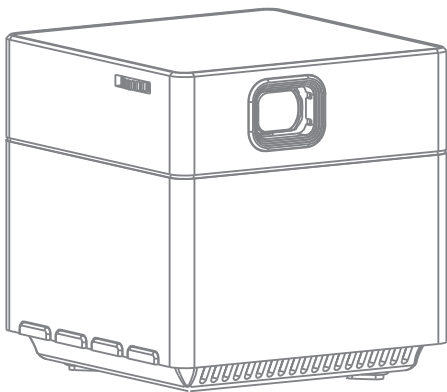

USER MANUAL



www.tenker.co



support@tenker.co



1-855-558-8666(24 Hours Mon-Fri)